

JDP-8 DRILL PRESS

- ◆ Precisely machined cast iron machine table with extension wings
- ◆ 13 mm drilling capacity
- ◆ Quiet 350 W induction motor
- ◆ 12 V halogene machine lamp with automatic ON
- ◆ Hinged belt and pulley cover for easy access
- ◆ Machine base with integrated tool tray
- ◆ Micro adjustable depth gauge
- ◆ The drill press comes complete with machine lamp, chuck guard and tool tray
- ◆ A 13 mm chuck and chuck key are supplied
- ◆ 60 x 60 mm vise is supplied

Stock number 230V	10000830M
Model	JDP-8
Motor: P₁	350 W
Spindle speeds: 5	550, 850, 1200, 1650, 2650 rpm
Spindle taper	B16
Spindle travel	50 mm
Chuck size	13 mm
Throat	100 mm
Table size with extensions	280 x 160 mm
Table tilt	+/- 90°
Weight	22 kg

JWL-1440L BENCHTOP WOOD LATHE

- ◆ 350 mm swing over bed allows turning of big bowls
- ◆ Big 1000 mm center distance
- ◆ Powerful 350 W induction motor
- ◆ 4 spindle speeds ranging from 800 to 2500 rpm for different workpiece diameters
- ◆ Hinged belt and pulley cover for convenient access
- ◆ Quick release levers for easy & accurate positioning of tool rest and tailstock
- ◆ The woodlathe comes complete with 300 mm toolrest, 145 mm face plate, spur center and life center

Stock number 230V	10000750M
Model	JWL-1440L
Swing over bed	350 mm
Center distance	1000 mm
Motor: P₁	350W S ₂ 30 min
Spindle speeds: 4	800, 1180, 1700, 2500 rpm
Spindle thread	1" x 8 TPI
Overall dimension	1450 x 290 x 340 mm
Weight	30 kg

Accessories

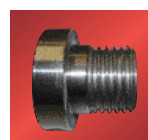

- ◆ 10000450 Adapter 1" x 8 TPI / M33x3.5